



BMX SUPERCROSS  
WORLD CUP

PAPENDAL  
THE NETHERLANDS

A group of BMX Supercross riders in various colored gear (orange, blue, black) are riding their bikes on a dirt track. They are in a line, leaning forward, and appear to be in the middle of a race or a practice run. The background shows trees and a cloudy sky.

# Competition guide

# 2018

# Content.



BMX SUPERCROSS  
WORLD CUP

PAPENDAL  
THE NETHERLANDS

Welcome & Introduction	3
Registration & Rules	4
Riders information	7
Access	14
Spectators information	17
Team information	19
About Arnhem & Gelderland	25
Partners	27



# Welcome & Introduction.



BMX SUPERCROSS  
WORLD CUP

PAPENDAL  
THE NETHERLANDS

As High Performance Centre Papendal, the City of Arnhem and Province of Gelderland we are proud to invite you to compete for the 2018 UCI BMX Supercross World Cup at Papendal, Arnhem.

Like in 2017 the UCI BMX Supercross Papendal presents two World Cup rounds, the first on Saturday the 5<sup>th</sup> of May and the second on Sunday the 6<sup>th</sup> of May 2018.

From Friday the 4<sup>th</sup> till Sunday the 6<sup>th</sup> of May 2018 we are organising a long weekend with three different events. Besides the elite sports BMX Supercross World Cup event, Papendal is the starting and finishing point for the Holland Classic, an event for recreational cyclists and mountain bikers. Last but not least there is our cultural event called Framed Festival. Music and foodtrucks: the recipe for pleasant chilling evenings with smoking BBQ, American burgers and music all around.

Papendal is surrounded by one of the most beautiful areas of nature in The Netherlands, so we are sure you will enjoy your stay. If you don't find all the necessary information in this competition guide, don't hesitate to contact us for any further information or assistance by e-mail [melissa.vandelft@papendal.nl](mailto:melissa.vandelft@papendal.nl).

We hope you will enjoy the event and your stay at Papendal!

Jochem Schellens,  
Director of High Performance Centre Papendal  
& Hotel and Conference Centre Papendal



## General information

The UCI BMX Supercross World Cup Papendal Arnhem will take place at the BMX track of Sport Centre Papendal, home of the Dutch National BMX Team.

From young promising athletes to world class athletes, the possibilities for (elite) sport are unlimited at Papendal. With its extensive experience, Papendal has been a very professional and reliable partner. Due to their wide knowledge of the requirements and demands of (elite) sport Papendal always performs at top level.

### Sport Centre Papendal

Papendallaan 3  
6816 VD ARNHEM  
The Netherlands





**BMX SUPERCROSS  
WORLD CUP**

**PAPENDAL  
THE NETHERLANDS**



# Registration & Rules

## Registration

You can enter through the UCI website ([www.uci.ch](http://www.uci.ch)) clicking as follows:

- **Web services** (homepage on the right side, 2<sup>nd</sup> last link)
- **UCI World Cups**
- **“Riders registration”**

Access: personal login and password of each National Federation.

All riders must enter through their National Federation or by the BMX Team registered with the UCI of which they are a member; no individual entries will be accepted. Only Junior and Elite riders can participate at the UCI BMX Supercross World Cup. Registration deadlines are indicated in the General Race Parameters.

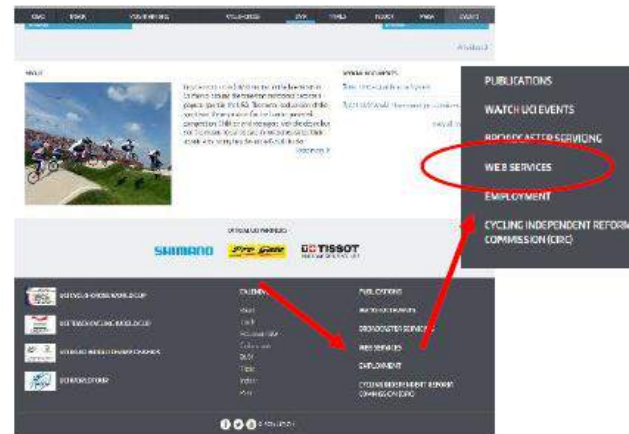

[http://regonline.uci.ch/layouts/login\\_Onlineservices.aspx?ReturnUrl=%2f](http://regonline.uci.ch/layouts/login_Onlineservices.aspx?ReturnUrl=%2f)

The name and the address of the hotel where the riders will stay must be given during the online registration.

## Entry payments

The entry fee for the 2018 UCI BMX Supercross World Cup is

**€ 250** for online registration. After the registration deadline the National Federation will receive an invoice by e-mail, sent by Papendal. There is a possibility to prepay the invoice or to pay on site cash (euros) or by credit card. In case of prepayment, the receipt needs to be taken to the competition. The entry fee must be paid for all entries not withdrawn before the online registration deadline, whether the rider(s) concerned are confirmed or not. For more information regarding prepayment please contact us: [melissa.vandelft@papendal.nl](mailto:melissa.vandelft@papendal.nl).

## Late registrations

Late registration is only possible through the National Federation or UCI BMX Team and until the riders' confirmation on site which is on the first training day between 08.30 - 10.30 hour. The entry fee for late registration is **€ 500** and must be paid immediately on site. Late entries are entries handled **after** the online registration deadline and **before** the riders' confirmation deadline. Once passed the riders' confirmation deadline no more late entries will be accepted.

Exchange rate: as per UCI financial obligations:

[http://www.uci.ch/mm/Document/News/News/18/01/19/BMX17Multi- Neutral.pdf](http://www.uci.ch/mm/Document/News/News/18/01/19/BMX17Multi-Neutral.pdf)

# Registration & Rules.



BMX SUPERCROSS  
WORLD CUP

PAPENDAL  
THE NETHERLANDS

## Rules

The UCI BMX Supercross World Cup is governed by the current 2018 regulations which you can find [HERE](#).

## Plates

Each rider will be assigned a front plate by the UCI when confirming the riders. These plates will be supplied by the UCI partner BOX Component and must be used by the riders.

## UCI officials

<b>UCI Technical Delegate</b>	Yvan Lapraz (SUI)
<b>President of the Commissaires' panel (PCP)</b>	Max Mager (SIN)
<b>Assistant PCP</b>	Jan Sykora (CZE)
<b>Secretary</b>	Christine Deconclois (FRA)
<b>3<sup>rd</sup> Commissaire</b>	Euan Goodman (GBR)
<b>Doping Control Officer (DCO)</b>	Silvia Galli (SUI)





**BMX SUPERCROSS  
WORLD CUP**

**PAPENDAL  
THE NETHERLANDS**

# Riders Information

## Riders confirmation

Riders registration is on Friday 4<sup>th</sup> of May between 08.30 – 10.30 hour at Hotel Papendal.

All riders/teams must attend the riders' confirmation on the first practice day, Friday 4<sup>th</sup> of May, between 08.30 and 10.30 presenting their license and picking up their race numbers. Riders not being confirmed before the indicated deadline did not complete the registration procedure and will not be able to compete at the event. Riders that were registered through the online system but that are unable to participate will still need to pay their entry fee to the organizer. The registration office is located at Hotel Papendal.

## Riders accreditation

All rainbow passes are delivered to the teams during the first event. If additional sporting passes are necessary the request needs to be send before the event to [kevin.maccuish@uci.ch](mailto:kevin.maccuish@uci.ch). For the request, please indicate the reason, the name and the contact details of the person for whom they are requested.

Passes will be distributed during riders' confirmation in the registration room.

## Riders access

All riders are provided with a wristband so they can access the premises. The wristband gives the riders also access to the seating area.

## Extra practice possibilities

This year we are organizing some extra trainings days at Papendal. All participants of the UCI BMX Supercross World Cup can participate.

### Date and time schedule

Tuesday 1<sup>st</sup> of May 2018 between 17.30 and 19.30\*

Wednesday 2<sup>nd</sup> of May 2018 between 17.30 and 19.30\*

*\*Only continues with at least 15 participants*

### Costs

- When staying at Hotel Papendal: € 20,- per rider per training.
- When staying in other hotels: € 25,- per rider per training.

Please make a reservation by sending an email to [evenementen@papendal.nl](mailto:evenementen@papendal.nl)

### Payment

- Payment at Servicedesk Arnhemhall, Papendallaan 9
- Payment is possible in cash, via pin payment or creditcard
- After payment you will receive an invoicement from the Service desk
- When showing your invoicement, you will get access to the BMX lane



## BMX Talent Cup

Just like last year there is a BMX Talent Cup on Friday the 4<sup>th</sup> of May. BMX-talents of 15 years and older will race at the official BMX Supercross track. All BMX-talents of 15 years and older and with a competition license of their National Federation can participate.

More info [bmxpapendal.com/talentcup](http://bmxpapendal.com/talentcup).

## Competition area

On the right side of the start hill will be an extra standing tribune.

## Framed Festival

As already mentioned in our introduction we are organising a long weekend of events from Friday the 4<sup>th</sup> till Sunday the 6<sup>th</sup> of May 2018. Besides the BMX Supercross World Cup event, Papendal is the starting & finishing point for the Holland Classic, an event for recreational cyclists and mountain bikers. Last but not least there is our cultural event called Framed Festival. Music and foodtrucks, that's the recipe for pleasant chilling evenings with smoking BBQ, American burgers and music all around. Riders will have free entrance to the festival, and entrance to the sitting tribune on the competition area.



## Day 0 – Thursday 3rd May

Start	Finish	Duration	Activity
14.00	20.00	06.00	Drop-off with car Team Area
19.00	19.30	00.30	Team Managers' Meeting (Hotel Papendal)

## Day 1 – Friday 4th May

Start	Finish	Duration	Activity
08.30	10.30	02.00	Riders' Confirmation
10.30			Stands open
11.00	15.30	04.30	World Cup - Official Practice
16.00	17.00	01.00	Talent Cup - Practise
17.30	19.30	02.00	Talent Cup - Competition
19.30	19.45	00.15	Award ceremony Talent Cup Papendal
20.00	20.15	00.15	<b>Dutch Remembrance Day Ceremony</b>

## Day 2 – Saturday 5th May

Liberation Day

Start	Finish	Duration	Activity
11.00			Stands open
11.00	14.00	03.00	Athlete practice
14.30	15.20	00.50	Men Round 1
15.20	15.30	00.10	Women Round 1
15.30	15.40	00.10	Break
15.40	16.05	00.25	Men – Last Chance
16.05	16.15	00.10	Women – Last Chance
16.15	16.25	00.10	Break
16.25	16.55	00.30	Men 1/16 Finals
16.55	17.15	00.20	Break
17.15	17.30	00.15	Men 1/8 Finals
17.30	18.00	00.30	Break
18.00	18.10	00.10	Women ¼ Finals
18.10	18.20	00.10	Men ¼ Finals

Start	Finish	Duration	Activity
18.20	18.25	00.05	Break
18.25	18.35	00.10	Women ½ Finals
18.35	18.40	00.05	Break
18.40	18.50	00.10	Men ½ Finals
18.50	19.00	00.10	Break
19.00	19.10	00.10	Women Finals
19.10	19.20	00.10	Men Finals
19.20	19.35	00.15	Awards Ceremony

## Day 3 – Sunday 6th May

Start	Finish	Duration	Activity
12.15			Stands open
11.45	12.45	01.00	Autograph session
12.45	13.45	01.00	Warm-up
14.00	14.50	00.50	Men Round 1
14.50	15.00	00.10	Women Round 1
15.00	15.10	00.10	Break
15.10	15.35	00.25	Men – Last Chance
15.35	15.45	00.10	Women – Last Chance
15.45	15.55	00.10	Break
15.55	16.25	00.30	Men 1/16 Finals
16.25	16.45	00.20	Break
16.45	17.00	00.15	Men 1/8 Finals
17.00	17.20	00.20	Break
17.20	17.30	00.10	Women ¼ Finals

Start	Finish	Duration	Activity
17.30	17.40	00.10	Men ¼ Finals
17.40	17.45	00.05	Break
17.45	17.55	00.10	Women ½ Finals
17.55	18.00	00.05	Break
18.00	18.10	00.10	Men ½ Finals
18.10	18.20	00.10	Break
18.20	18.30	00.10	Women Finals
18.30	18.40	00.10	Men Finals
18.40	18.55	00.15	Awards Ceremony

## Awards/trophies

The **trophies** will be awarded to the first three riders of each category at the awards ceremony.

## Prize Money

High Performance Centre Papendal will pay equal prize money in accordance with the table found on this page. Prize money will be paid in Euros by our bank-account, so please fill in the form when you have won prize money\* at [www.bmxpapendal.com/ranking](http://www.bmxpapendal.com/ranking) before the 1<sup>st</sup> of September 2018.

\*data: (1) Name, (2) Address, (3) IBAN-number, (4) BIC/SWIFT-code, (5) Bank name, (6) Bank Address (7) Country and (8) ID.

Price per race

	Men Elite	Women Elite
	Per race	Per race
<b>1</b>	<b>€ 2500</b>	<b>€ 2500</b>
<b>2</b>	€ 1500	€ 1500
<b>3</b>	€ 1000	€ 1000
<b>4</b>	€ 700	€ 700
<b>5</b>	€ 550	€ 550
<b>6</b>	€ 450	€ 450
<b>7</b>	€ 375	€ 375
<b>8</b>	€ 325	€ 325
<b>5 ½</b>	€ 275	€ 275
<b>6 ½</b>	€ 275	€ 275
<b>7 ½</b>	€ 250	€ 250
<b>8 ½</b>	€ 250	€ 250
	<b>€ 9500</b>	<b>€ 9500</b>

General ranking price

	Men Elite	Women Elite
	Per race	Per race
<b>1</b>	<b>€ 10.000</b>	<b>€ 10.000</b>
<b>2</b>	€ 6.000	€ 6.000
<b>3</b>	€ 4.000	€ 4.000
<b>4</b>	€ 1.900	€ 1.900
<b>5</b>	€ 1.600	€ 1.600
<b>6</b>	€ 1.400	€ 1.400
<b>7</b>	€ 1.200	€ 1.200
<b>8</b>	€ 1.000	€ 1.000
<b>9</b>	€ 650	€ 650
<b>10</b>	€ 600	€ 600
<b>11</b>	€ 500	€ 500
<b>12</b>	€ 450	€ 450
<b>13</b>	€ 400	€ 400
<b>14</b>	€ 350	€ 350
<b>15</b>	€ 300	€ 300
<b>16</b>	€ 250	€ 250
	<b>€ 30.600</b>	<b>€ 30.600</b>



**BMX SUPERCROSS  
WORLD CUP**

**PAPENDAL  
THE NETHERLANDS**



# Access

## Airports

Schiphol, Amsterdam Airport (100 km)	<a href="http://www.schiphol.nl">www.schiphol.nl</a>
Rotterdam Airport (106 km)	<a href="http://www.rotterdam-airport.nl">www.rotterdam-airport.nl</a>
Eindhoven Airport (89 km)	<a href="http://www.eindhovenairport.nl">www.eindhovenairport.nl</a>
Airport Weeze (51 km)	<a href="http://www.airport-weeze.de">www.airport-weeze.de</a>
Düsseldorf International (135 km)	<a href="http://www.duesseldorf-international.de">www.duesseldorf-international.de</a>
Brussels Airport (208 km)	<a href="http://www.brusselsairport.be">www.brusselsairport.be</a>

## Public transportation

Go to Arnhem Central Station by train. Then, take bus 105 (direction Barneveld) to bus stop 'West End/Papendal'. From that point, it is a 10 minute walk to Hotel Papendal.

From Monday to Friday, between 7 am and 6 pm (holidays excluded) it is also possible to take bus 10 (direction 'Sportcentrum Papendal'). This bus goes directly to our site. From the bus stop it is a 5 minute walk to the venue.

### *Breng flex*

You can also download the 'Breng flex app' of the same bus-company as bus 10 above mentioned. When you book a ticket using the app (€ 3,50) they will take you, from every bus stop in Arnhem, directly to Papendal: <https://www.breng.nl/brengflex/1411> (only in Arnhem!).

### *Papendal Taxi*

If you would like to take a taxi from Arnhem Station, you can call Taxi Company Linsen (+3126-474 22 95) and ask for a Papendal-taxi. It costs € 12,50 one-way. Please wait at the 'Sonsbeekzijde' (Sonsbeek-side) of the station. The Papendal taxi drives between 07.00 am till 12.00 pm.

## By car

From the west (Amsterdam, Leiden, Den Haag, Utrecht)

- A12 direction Arnhem
- exit 25: enter N224
- on N224: turn right direction
- after 1.5 kilometer: take exit Papendal

From the north/east (Groningen, Assen, Zwolle, Apeldoorn):

- A50 direction Arnhem
- follow A12 direction Utrecht
- exit 25: enter N224
- on N224: turn left, direction Arnhem
- after 1.5 kilometer: Papendal exit

From the south (Rotterdam, Venlo, Eindhoven, 's Hertogenbosch):

- A50 direction Arnhem
- follow A12 direction Utrecht
- exit 25: enter N224
- on N224: turn left, direction Arnhem
- after 1.5 kilometer: exit Papendal

# Sidemap.



BMX SUPERCROSS  
WORLD CUP

PAPENDAL  
THE NETHERLANDS

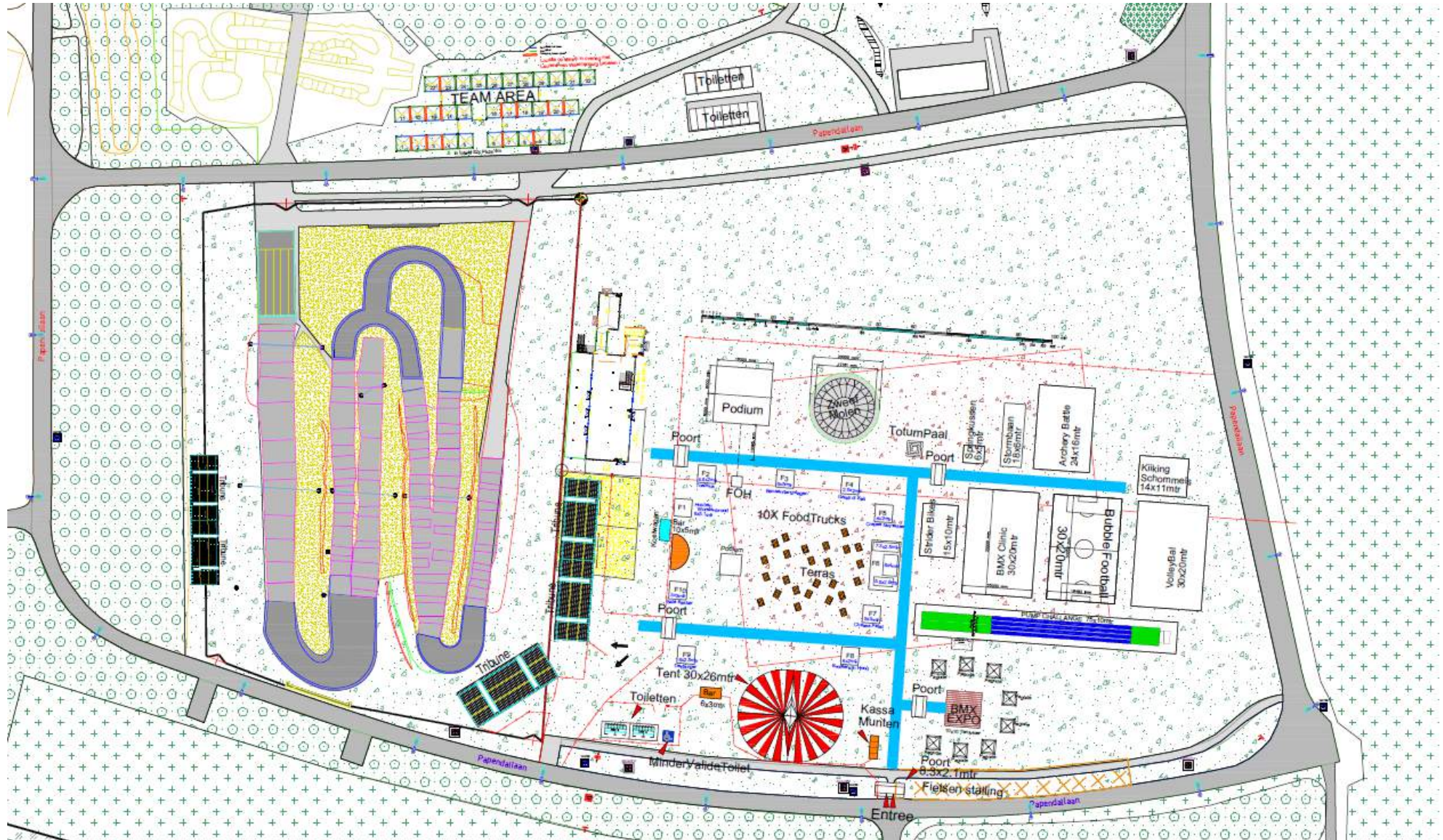





**BMX SUPERCROSS  
WORLD CUP**

**PAPENDAL  
THE NETHERLANDS**

# Spectators Information



## Parking

Parking is available on the premises of Papendal. Please follow the signage.

## Ticket sale

The tickets are for sale by the following link: [www.bmxpapendal.nl/tickets](http://www.bmxpapendal.nl/tickets). Each electronic ticket should be printed beforehand to allow the access to the event. The riders, coaches and team managers don't pay their tickets.

## Framed festival

Visit Framed Festival where you can enjoy good music and foodtrucks, with smoking BBQ, American burgers and live entertainment. Your ticket for BMX will also give you a free entrance to Framed Festival.

## VIP Package

Watch world class BMX racing with an exclusive view!

### VIP Lounge

€ 100,- p.p. per day

- Entrance to the festival grounds
- Entrance to the BMX track VIP Lounge
- 1 VIP parking ticket per 2 persons
- Beverage package
- Mixed appetizers

### Business Lounge

€ 150,- p.p. per day

- Entrance to the festival grounds
- Entrance to the BMX track VIP Lounge
- 1 VIP parking ticket per 2 persons
- Beverage package
- Food package

To book or for more information please e-mail [melissa.vandelft@papendal.nl](mailto:melissa.vandelft@papendal.nl).

## More information online

Join, follow and share the 2018 UCI BMX Supercross World Cup at Papendal, Arnhem

Facebook:

[www.facebook.com/bmxpapendal](http://www.facebook.com/bmxpapendal)

Instagram:

[www.instagram.com/papendal](http://www.instagram.com/papendal)

Twitter:

<https://twitter.com/BMXPapendalLive>

Official website:

<http://bmxpapendal.com/>



BMX SUPERCROSS  
WORLD CUP

PAPENDAL  
THE NETHERLANDS



# Team Information

## Team bibs

Team BIBs will be provided for National Teams and UCI BMX Teams (1 or 2 per nation, depending on the number of entries from that team) by the Secretary during the riders confirmation. This takes place on the first practice day (Friday 4<sup>th</sup> May) between 08.30- 10.30 at the registration room. Teams will be asked to pay **€ 100** deposit.

The team BIBs give access to allocated places explained by the PCP during the Team Managers meeting. The bibs need to be returned to the Secretary before the qualification motos start. You will also get the deposit back at that time.



## Team areas

The team areas are situated behind the start hill. Team Areas are not accessible for cars. They need to be parked close to the team venue on the special VIP parking.

## Parking

Parking for teams and riders is possible on the VIP parking. This parking is clearly indicated and the car must be provided with a parking card. You will receive the parking card at the riders conformation.

## Team managers meeting

The Team Managers meeting will be held at 19.00 on Thursday, 3rd of May at Hotel Papendal.

## Training opportunities

This year we are organizing some extra trainings days at Papendal. All participants of the UCI BMX Supercross World Cup can participate. Date and time schedule: Tuesday 1<sup>st</sup> of May 2018 between 17.30 and 19.30 and Wednesday 2<sup>nd</sup> of May 2018 between 17.30 and 19.30. Please make a reservation by sending an email to [evenementen@papendal.nl](mailto:evenementen@papendal.nl)

The Papendal BMX track will not be open for (non-event) practice during the event week. The BMX Track can be booked for practise up until Sunday April 30. This can be booked through Sport Centre Papendal. To book time on the track and for more information about availability and prices please contact:

Henny Kroon, [henny.kroon@papendal.nl](mailto:henny.kroon@papendal.nl).

There are several other BMX tracks that will be able to offer training for teams and individuals.

Kampen (Ned),

To book time and find out more about charges and availability please email Rudy van Dijk, [rudy@zeinstravandijk.nl](mailto:rudy@zeinstravandijk.nl), or phone +31 6 5588 6003

Zolder (Bel),

To book time and find out more about charges and availability please email Jef Simons, [jef.simons@circuit-zolder.be](mailto:jef.simons@circuit-zolder.be), or phone +32 1185 8874

## Team area tents

All teams can have a 4 x 4 metre tent (13,1' x 13,1') at their disposal in the team area. A table and chairs are included.

A tent in the team area can be rented by teams for **€ 595**. Also it is possible to rent more than one tent; they will be connected to create one large space.

PLEASE NOTE: At the Team Area, located in zone 2 close to the start hill, there is room for **24 team tents**. If the number of reservation exceeds 24, we will place the other tents at a secondary location. Spaces will be allocated on a first come, first serve base. There is a possibility to prepay the invoice or to pay on site cash (euros) or by credit card. In case of prepayment, the receipt needs to be taken to the competition. Please note that bookings cannot be cancelled.

Team Areas will be accessible from 09.00 Friday 4th of May to Sunday 6th of May 20.00.

The **dropp-off** and the unloading of team equipment can only be on Thursday from 12:00 to 20:00 and Friday morning from 08.30 to 10.00.

**Equipment removal** can be done on Sunday 6th may from 20.00. Every tent must be cleared out by teams before 22:00.

## Tent rental team area – UCI BMX Supercross Papendal

We'd like to rent.....(number of tents) during the UCI BMX Supercross,

4 & 5 & 6 May 2018



### Specifications:

- €595 per tent
- 4 x 4 metres (13,1' x 13,1')
- Table and chairs included
- Tents are connectable
- Payment can be made before (by bank) or upon arrival: cash or credit card
- Once booked, tents can't be cancelled

### IMPORTANT:

**Due to the lay-out of the Supercross terrain, the organization will not allow teams to bring their own tents.**

Team: .....

Contact: .....male/female

E-mail: .....

Telephone .....(during event)

*In case of emergency:*

Name hotel: .....(during event)

City: .....

Please return this form no later than April 21<sup>st</sup>

Email: [melissa.vandelft@papendal.nl](mailto:melissa.vandelft@papendal.nl)

## Medical Cover

A team of doctors and paramedics will be present throughout practise and racing. The team will be based on the track and also have use of a medical room at the bottom of the start ramp.

The medical team will be available at the following times:

### Official Practice Day

Friday May 4, 2017                      12:30 PM to 06:00 PM

### Competition Days

Saturday May 5, 2017                      11:00 AM to 07:30 PM

Sunday May 6, 2017                      01:00 PM to 07:00 PM

The nominated hospital:

### Hospital Rijnstate

Wagnerlaan 55  
6815 AD Arnhem  
+31 (0)26 378 8888

Be advised; when visiting the hospital you will need to bring;

1. Copy of ID/Passport, address, postal code and place of residence.
2. Copy of assurance / health care incl. phone number

## Rider & Team Manager Seating

The team managers and riders have access to the seating area to watch the race. A not reserved sitting area. This will be accessed using an accreditation or wristband. There will also be a small area for Team Managers trackside on the start straight.

## Water

We recommend to drink tap water or bottled water.

## Food

There will be a number of concessions stands at the venue. We will also offer teams to purchase healthy lunch packages that will be delivered on site. These lunch packages can be reserved and purchased during the team manager meeting. Or please contact Melissa van Delft, [melissa.vandelft@papendal.nl](mailto:melissa.vandelft@papendal.nl).

## Travel & accommodation

### Official hotel

For accommodation during the UCI BMX Supercross World Cup, the Hotel Papendal with its comfortable four-star rooms is a perfect choice. Hotel Papendal is situated in woody surroundings and is within walking distance from the BMX track. Special discount rates apply for sports federations. Hotel Papendal offers the athletes and their staff the possibility to book a BMX-arrangement for this period at a special price.

Please contact Caroline van Kooten: [caroline.vankooten@papendal.nl](mailto:caroline.vankooten@papendal.nl)

Hotel Papendal  
Papendallaan 3  
6816 VD ARNHEM  
Tel: +31 (0)26 483 79 11

### Preferred hotels

The Bilderberg hotels are near High Performance Centre Papendal, these surrounding has been named to be the greenest surrounding of Holland. Bilderberg is ideal for training camps and strategic preparations for your team.

Hotel De Bilderberg  
Utrechtseweg 261  
6862 AK Oosterbeek  
Tel: +31 (0)26 339 63 33

E: [bilderberg.reservation@bilderberg.nl](mailto:bilderberg.reservation@bilderberg.nl)

Bilderberg Hotel De Buunderkamp  
Buunderkamp 8  
6874 NC Wolfheze  
Tel: +31 (0)26 48211 66

E: [buunderkamp.reservation@bilderberg.nl](mailto:buunderkamp.reservation@bilderberg.nl)



## Media & Key contacts

### Media

All media planning to attend the event must be accredited in order to gain access to the venue. To apply for a press accreditation for the UCI BMX Supercross at Papendal you are obliged to fill in the form on the website [www.bmxpapendal.com](http://www.bmxpapendal.com). To be awarded for an accreditation you need to be in possession of a valid press card. For any questions contact our press officer directly: [angelique.vandongen@papendal.nl](mailto:angelique.vandongen@papendal.nl) / +31 6 10537846.

### Key Contacts

#### Sport & Technical Aspects UCI

Sporting and technical aspects, event management and coordination:  
Mr. Kevin MacCuish, UCI BMX coordinator, [kevin.maccuish@uci.ch](mailto:kevin.maccuish@uci.ch)

#### Sport & Technical Aspects Papendal

The organizing committee has appointed a coordinator Rudy van Dijk to act as the main point of contact between participants and the organizers. He will be available at the event to answer any enquiries.

Rudy van Dijk, [rudy@zeinstravandijk.nl](mailto:rudy@zeinstravandijk.nl), +31 6 5588 6003.

#### Local Organising Committee

The 2018 UCI BMX Supercross at Papendal, Arnhem is organized by:

High Performance Centre Papendal

Papendallaan 9  
6816 VD Arnhem  
The Netherlands  
+31 26 483 4537

E-mail: [laurens.vanwaardenburg@papendal.nl](mailto:laurens.vanwaardenburg@papendal.nl)

Website: [www.bmxpapendal.com](http://www.bmxpapendal.com)







BMX SUPERCROSS  
WORLD CUP

PAPENDAL  
THE NETHERLANDS

# About Arnhem & Gelderland

# About Arnhem & Gelderland.



BMX SUPERCROSS  
WORLD CUP

PAPENDAL  
THE NETHERLANDS

Arnhem is situated in the province of Gelderland, famous for its wonderful forests and cultural habitats. For style and culture, visit Arnhem and the province. Here you find the famous Kröller-Müller Museum with its extensive sculpture garden. The Netherlands Open Air Museum, the famous Ouwehands Zoo and Burgers' Zoo are also close at hand. And of course the Airborne Museum. Discover the wonderful forests of the National Park "De Hoge Veluwe". This park is the largest continuous national park in the Netherlands. The area consists of 5,400 hectares of forest, heathland, marshland and drift-sand. There is a great diversity of plant and animal species and the Park is home to very rare species of thrush. Together with the Jachthuis Sint Hubertus, the Visitor Centre/Museonder, the Kröller-Müller Museum and the statues garden, the Park forms a unique and (inter)nationally famous combination of nature, art and architecture.

Arnhem is a bustling town where you will never get bored. Whatever your interests - shopping, going out, culture, or the countryside - might be. The historic town centre of Arnhem is definitely worth a visit. Restored to their former glory and joined underneath one of the shopping streets, the 40 medieval cellars show you what underground Arnhem used to look like. The history of the town is reflected in the town centre itself as well as in 100-year-old Sonsbeek park, where you can take a rest in the heart of the town! The Church of Eusebius dominates the skyline. This late Gothic ogive basilica boasts a unique glass lift, rising to 73 meters and offering you a view of the centre. On your way up you will also see the biggest carillon in Europe! Arnhem has been one of the most attractive shopping areas in the Netherlands for years, boasting a range of large chain stores and little clothes shops. Arnhem has turned into an attractive town for those with a passion for fashion. Your day, evening or weekend in Arnhem should not end until you have been to Korenmarkt, the bustling entertainment centre.

To discover more about Arnhem & Gelderland visit:

<http://www.vvvarnhemnijmegen.nl/arnhem>

<http://www.geldersestreken.nl/>



# Partners.

## Main sponsors



## Official sponsors



## Official partners

