

One Speed Self-Tailing Winch

16st

HARKEN®

Winch Parts and Service Instructions

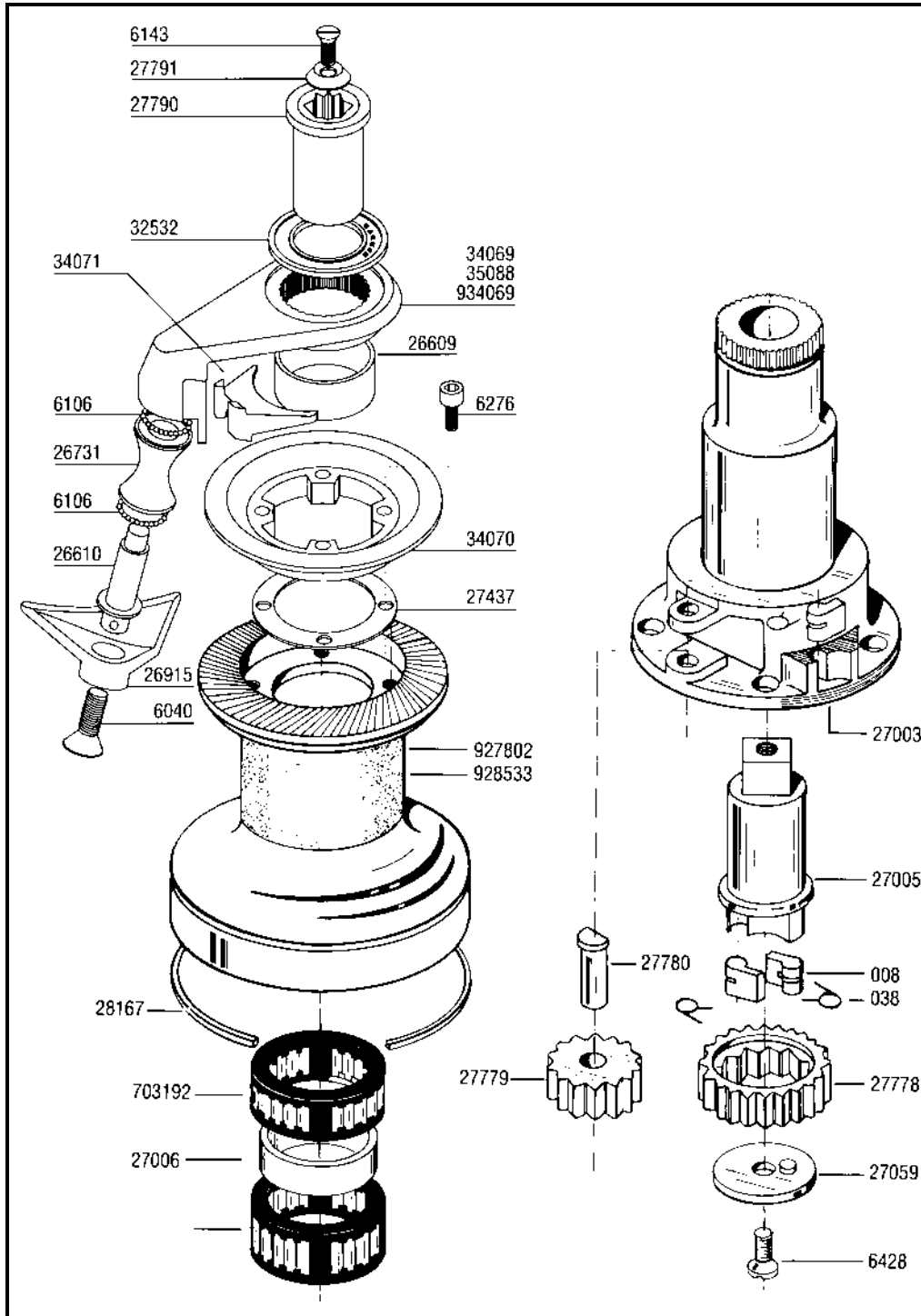

Tools Required

Screwdriver
Allen Wrench (4mm)
Plastic Head Hammer or Mallet
Small Knife
Brush
Rags
Solvent
Oil
Grease

Parts List

008	Pawl
038	Pawl Spring
6040	Screw
6106	Ball (32 required)
6143	Top Screw
6276	Screw
6428	Screw
26609	Spacer
26610	Roller Shaft
26731	Roller
26915	Guide Arm
27003	Center Stem
27005	Spindle
27006	Bearing Spacer
27059	Cover Plate
27437	Adjustment Spacer
27778	Ratchet Gear
27779	Gear
27780	Gear Shaft
27790	Handle Socket
27791	Plastic Washer
28167	Red Line Ring
32532	Top Cap
34069	Chrome Stripper Arm
34070	Upper Jaw
34071	Line Peeler
35088	Bronze Stripper Arm
703192	Bearing
927802	Aluminum Drum
928533	Chrome Drum
934069	Chrome Stripper Arm Assembly

Suggested Service Kits

BK4512	10 Pawls 008
	10 Springs 038
BK4513	100ml Grease

When ordering parts for service, please include a "B" before each number (i.e. B008).

Recommended Service Cycle – Service winch before the sailing season and once during.

Adjusting Self-Tailer

Self-tailing winches must be adjusted for line size to insure proper operation. If the line slips in the jaws, remove the adjustment spacer 27437 from under the upper jaw 34070. If the winch self-tails properly with the spacer in place, do not remove it. The efficiency of the winch will be compromised when using larger lines.

Positioning Stripper Arm

Loosen top screw
Remove handle socket
Lift stripper arm and drum; position as desired

Opening Winch

Remove top screw
Lift off drum and stripper arm

Servicing Winch

Remove pawls and springs - service as below
Remove bearings, gear shaft and gears
To remove center spindle, winch must be removed from deck
Clean all parts with rags and solvent
Use a brush to lubricate all moving parts lightly with grease
Replace pawls and springs and lubricate lightly with oil
Reassemble and close winch

Servicing Pawls

Catch spring with knife and hold against pawl
Lift out pawl
Clean and check for wear
Place spring against pawl with straight leg against pawl
Hold spring closed and slip pawl into pawl socket
Lubricate pawls using oil

Fitting on Boat

Make sure mounting surface is flat
Check sheet entry angle
Open winch
Position winch on deck with drive gear where sheet enters winch drum and mark holes
Remove winch and drill holes
Mount using five 1/4" (6mm) flat head machine screws
Apply bedding compound and bolt winch to boat
Clean excess bedding compound from base drain holes
Lubricate and reassemble winch

Adjusting Self-Tailer

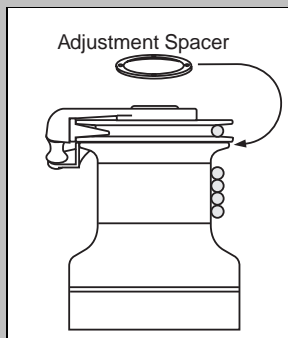

To adjust self-tailer, add or remove adjustment spacers.

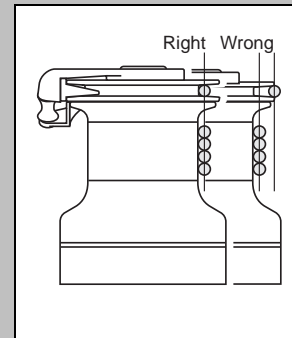

Correct opening: Sheet fits completely into jaw and rests against drum.

Servicing Winch



Clean all parts with solvent.

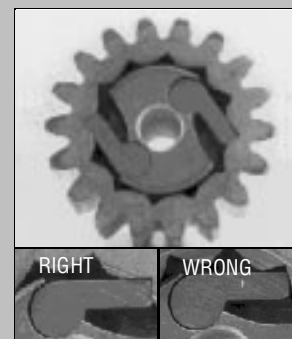

Grease lightly and spread grease evenly. Use a brush.

Attention: Ratchet gear mounted backwards will cause winch to slip.

Servicing Pawls



Use knife to free captive spring.

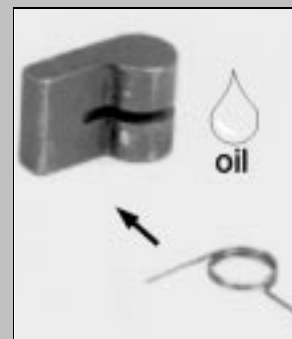

Insert spring with straight leg against pawl. Use oil for lubrication.

Fitting on Boat

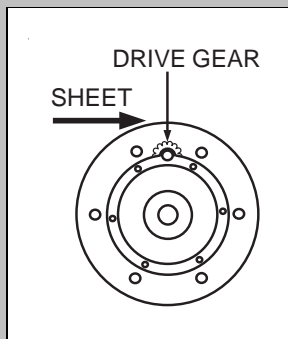

Position drive gear where sheet enters winch drum.

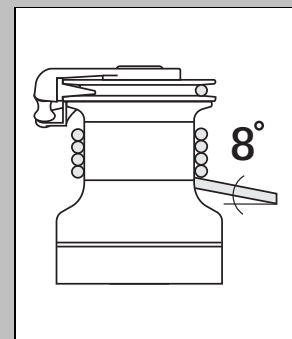

Sheet angle must be at least 8°.